

Ecoflam

LIGHT OIL RANGE

MAX



www.ecoflam-burners.com

CUSTOMIZED BURNERS SOLUTIONS FOR ANY TYPE OF APPLICATION



OUR EXPERIENCE

Thanks to almost 50 years of experience in the design and production of burners, Ecoflam offers a full range of blown air pressure jet burners covering an extremely wide range of power, from small products for residential heating applications to high power burners dedicated to the industrial segment.

Ecoflam burners are renowned worldwide for providing high efficiency and reliable operation with significant energy savings and feature extreme ease of installation, maintenance and flexible boiler-burner matching.

OUR MISSION

Following a philosophy of continuous improving, the R&D Laboratory is constantly working to produce better results, such as the reduced NOx level emissions. The development of new advanced combustion technologies allows to propose solutions in respect of the most stringent environmental regulations and to create the perfect condition to face the new upcoming market requests, such as Ultra Low NOx performance and ErP-ready products.



OUR PRODUCT RANGE

The flexibility of Ecoflam solutions allows the manufacturing of highly customized products covering a range from 17 kW to 34 MW:



MAX GAS

Gas range
17 - 700 kW



BLU

Gas range
245 - 17000 kW



MAX

Light oil range
18 - 546 kW



MAIOR

Light oil range
300 - 17000 kW

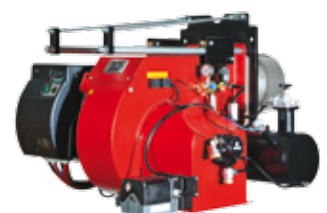

MAXFLAM/OILFLAM

Heavy oil range
68 - 17000 kW



OUR PROFESSIONAL TEAM

Ability to design state-of-the-art burners, manage demands of products for specific applications, ability to solve problems in real time are just some of the characteristics of our technicians and engineers.

But not only: Ecoflam has a worldwide network of service technicians able to support the installation, the commissioning and the periodic maintenance activities of the burner.

OUR INTERNATIONAL APPROACH

Our products are designed, developed and manufactured in Italy, combining quality, reliability and high performance. All these features are necessary for the end-user satisfaction, which is the first target for Ecoflam. Reaching this outcome throughout its extensive worldwide network of distributors and customers has always been a challenging task for Ecoflam, which was achieved only by developing a close and personalized relationship with each customer, always taking into account the needs and the distinctive characteristics of each individual market.



MULTICALOR

Dual fuel (gas/light oil)
190 - 17000 kW

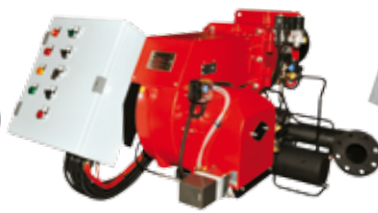

MULTIFLAM

Dual fuel (gas/heavy oil)
414 - 17000 kW



TS RANGE

All fuels
230 - 34000 kW



SPECIAL VERSIONS

RANGE OVERVIEW

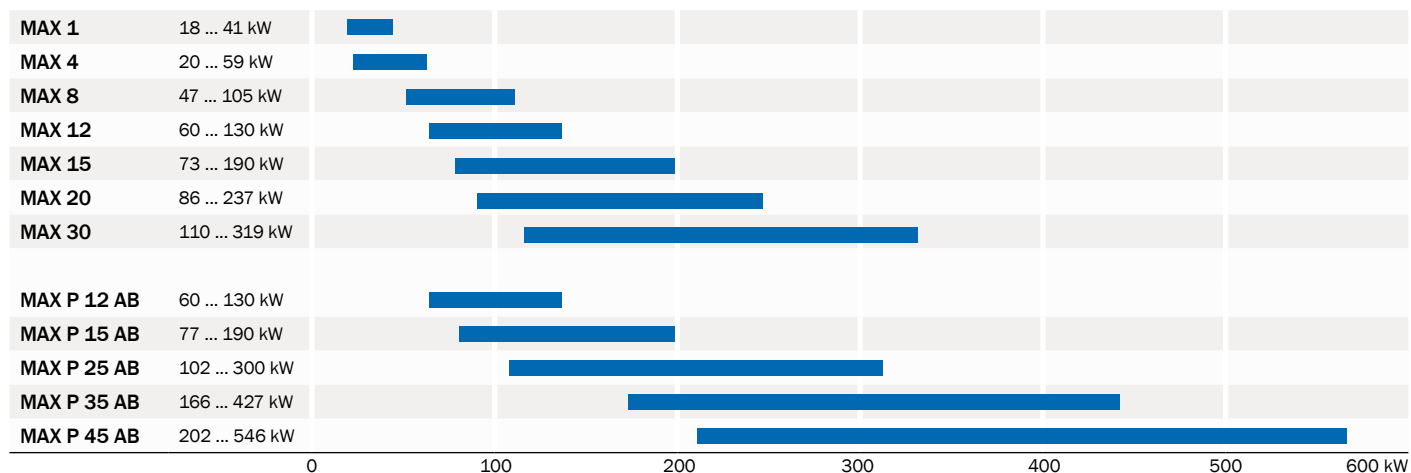

MAIN FEATURES

- High efficiency fan ventilation system (HPV) allowing easy matching with boilers having high combustion chamber back pressure
- Electrical wiring simple to disassemble for easy maintenance
- Combustion head easy to assemble and adjust
- The hinge flange allows easy access to burner head without losing burner settings (MAX 35 and MAX 45)
- Models from MAX 1 to MAX 12 work with 50-60 Hz electrical frequency



CONFIGURATIONS

MAX range is available in the following operation modes:

MAX	One stage	All models
MAX P ... AB	Two stages	MAX P 35 AB - P 45 AB
MAX P ... AB HS	Two stages with hydraulic jack	MAX P 12 AB HS ... P 45 AB HS

Other available configurations:

- Continuous ventilation versions
- High temperature versions
- Versions with specific pump for light oil with maximum viscosity 5° E at 20 °C
- OEM and other special versions on request according to feasibility

FUEL

- Light oil (viscosity from 1,6 cSt to 6 cSt at 20 °C)

EMISSIONS

Class	NOx mg/kWh
1	250
2	185
3	120

All models are in compliance with EN 267 European Standard

CONFORM TO

All products are in accordance with the following directives:

- 2006/42/EC Machinery Directive
- 2014/30/UE EMC Directive
- 2014/35/UE Low Voltage Directive



- Fuel: light oil (viscosity from 1,6 cSt to 6 cSt at 20 °C)
- Operation: one stage
- Emission class: Low NOx class 2 (≤ 185 mg/kWh) according to EN267

WORKING DIAGRAM

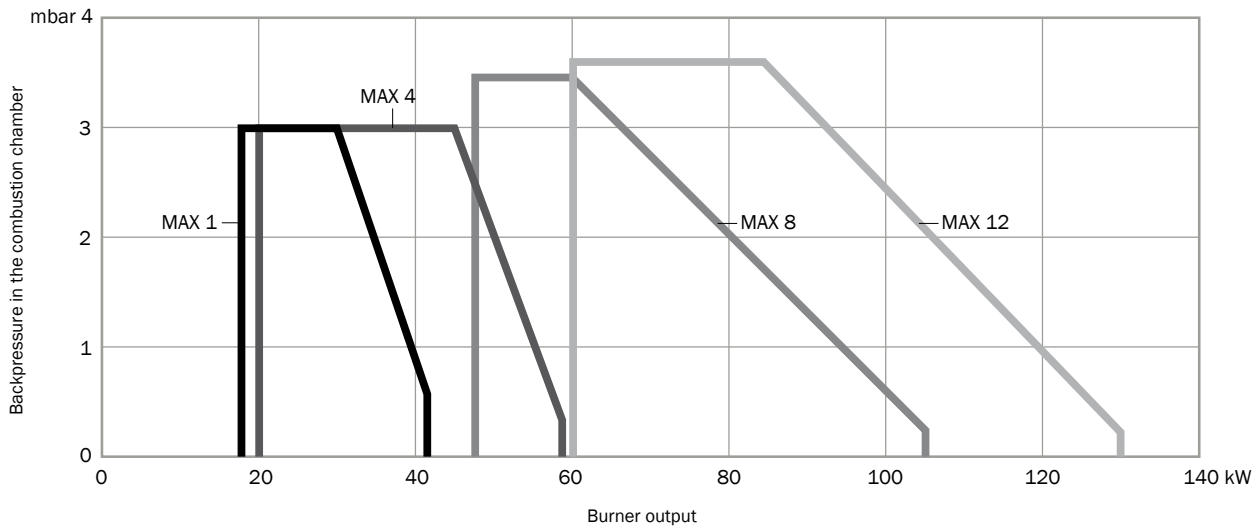

TECHNICAL DATA

	Burner output (kW)	Flow rate (kg/h)	Power supply	Motor (W)	NOx class	Operation
MAX 1	18 - 41	1,5 - 3,5	1/230V/50-60Hz	75	Class 2	1 stage
MAX 4	20 - 59	1,7 - 5	1/230V/50-60Hz	75	Class 2	1 stage
MAX 8	47 - 105	4 - 8,9	1/230V/50-60Hz	100	Class 2	1 stage
MAX 12	60 - 130	5,1 - 11	1/230V/50-60Hz	130	Class 2	1 stage

OVERALL DIMENSIONS

MAX 1

MAX 4 - 8 - 12

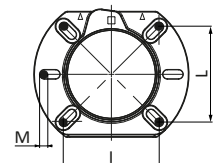
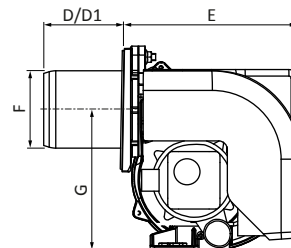
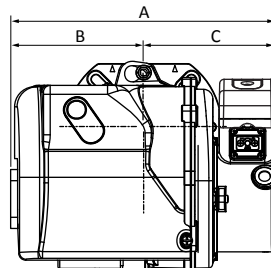
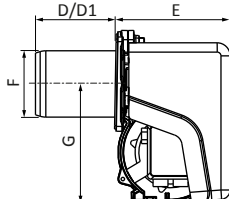
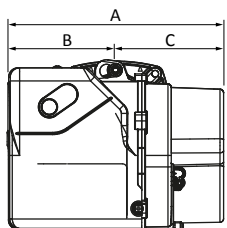

Dimensions in mm
 Head length: D short / D1 long

	A	B	C	D	D1	E	F	G	I	L	M
MAX 1	288	143	145	80	140	153	89	160	92/107	92/107	M8
MAX 4	297	149	148	90	145	204	89	160	90/107	90/107	M8
MAX 8	303	155	148	90	145	204	89	160	100/120	100/120	M8
MAX 12	317	169	148	100	155	204	98	160	100/120	100/120	M8

- Fuel: light oil (viscosity from 1,6 cSt to 6 cSt at 20 °C)
- Operation: one stage
- Emission class: Low NOx class 2 (≤ 185 mg/kWh) according to EN267

WORKING DIAGRAM

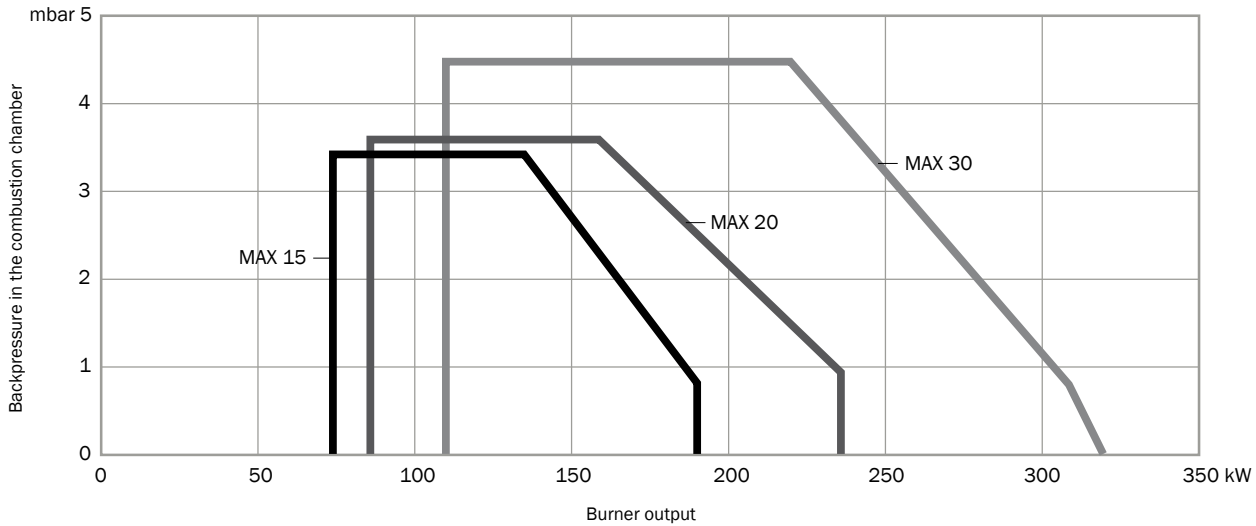

TECHNICAL DATA

	Burner output (kW)	Flow rate (kg/h)	Power supply	Motor (W)	NOx class	Operation
MAX 15	73 - 190	6,2 - 16	1/230V/50Hz	130	Class 2	1 stage
MAX 20	86 - 237	7,3 - 20	1/230V/50Hz	200	Class 2	1 stage
MAX 30	110 - 319	9,3 - 27	1/230V/50Hz	200	Class 2	1 stage

OVERALL DIMENSIONS

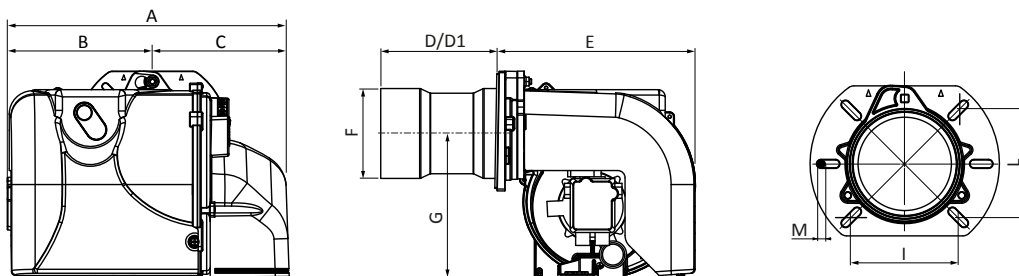

Dimensions in mm
 Head length: **D** short / **D1** long

	A	B	C	D	D1	E	F	G	I	L	M
MAX 15	392	202	190	160	260	276	107	201	120/131	120/131	M8
MAX 20	392	202	190	160	260	276	125	201	120/131	120/131	M8
MAX 30	392	202	190	160	260	276	125	201	120/131	120/131	M8

Range | Models
MAX P 12 HS - P 15 HS - P 25 HS

- Fuel: light oil (viscosity from 1,6 cSt to 6 cSt at 20 °C)
- Operation: two stages with hydraulic jack
- Emission class: Low NOx class 2 (≤ 185 mg/kWh) according to EN267

WORKING DIAGRAM

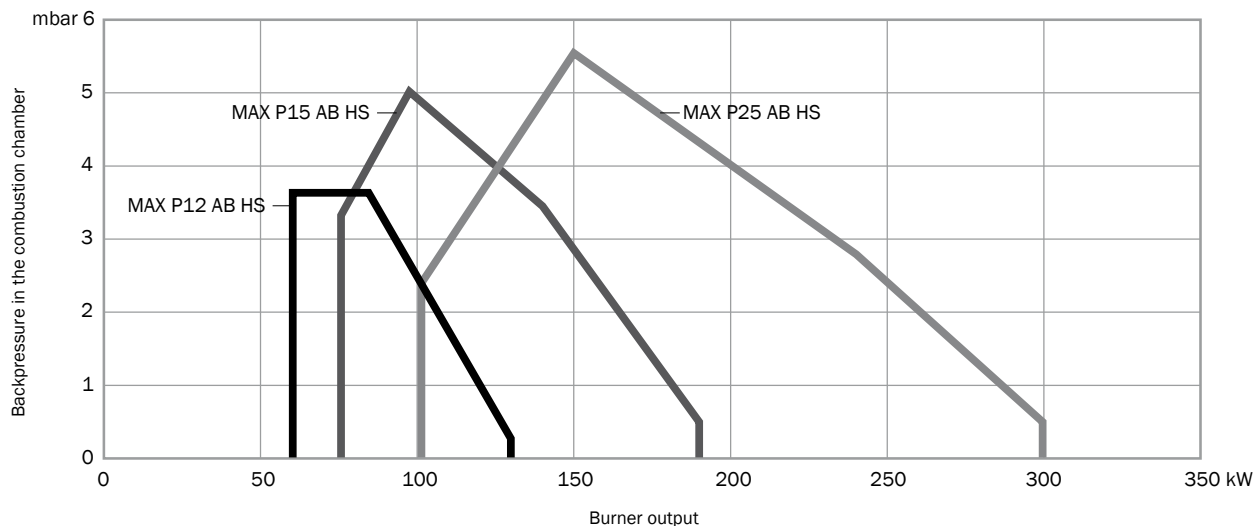

Test conditions conforming to EN267
 Temperature: 20 °C
 Pressure: 1013,5 mbar
 Altitude: 0 m a.s.l.

TECHNICAL DATA

	Burner output (kW)	Flow rate (kg/h)	Power supply	Motor (W)	NOx class	Operation
MAX P 12 AB HS	60 - 130	5,1 - 11	1/230V/50-60Hz	130	Class 2	P AB HS
MAX P 15 AB HS	77 - 190	6,5 - 16	1/230V/50Hz	130	Class 2	P AB HS
MAX P 25 AB HS	102 - 300	8,6 - 25,4	1/230V/50Hz	200	Class 2	P AB HS

OVERALL DIMENSIONS

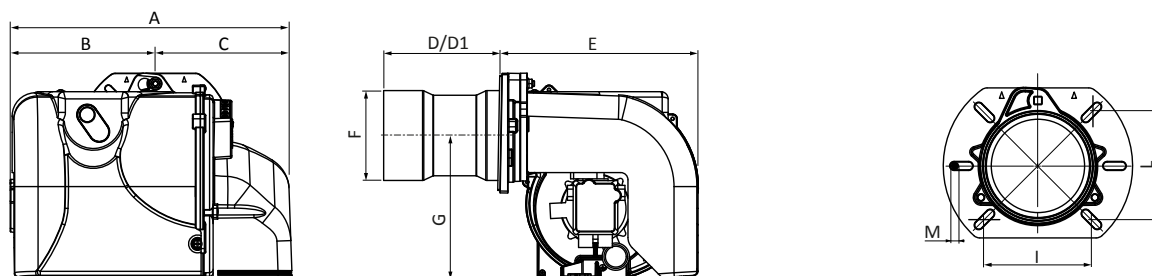

Dimensions in mm
 Head length: D short / D1 long

	A	B	C	D	D1	E	F	G	I	L	M
MAX P 12 AB HS	308	169	139	100	155	204	98	160	100/120	100/120	M8
MAX P 15 AB HS	392	202	190	160	260	276	107	201	120/131	120/131	M8
MAX P 25 AB HS	392	202	190	160	260	276	125	201	120/131	120/131	M8

- Fuel: light oil (viscosity from 1,6 cSt to 6 cSt at 20°C)
- Operation: two stages and two stages with hydraulic jack
- Emission class: Low NOx class 2 (≤ 185 mg/kWh) according to EN267

WORKING DIAGRAM

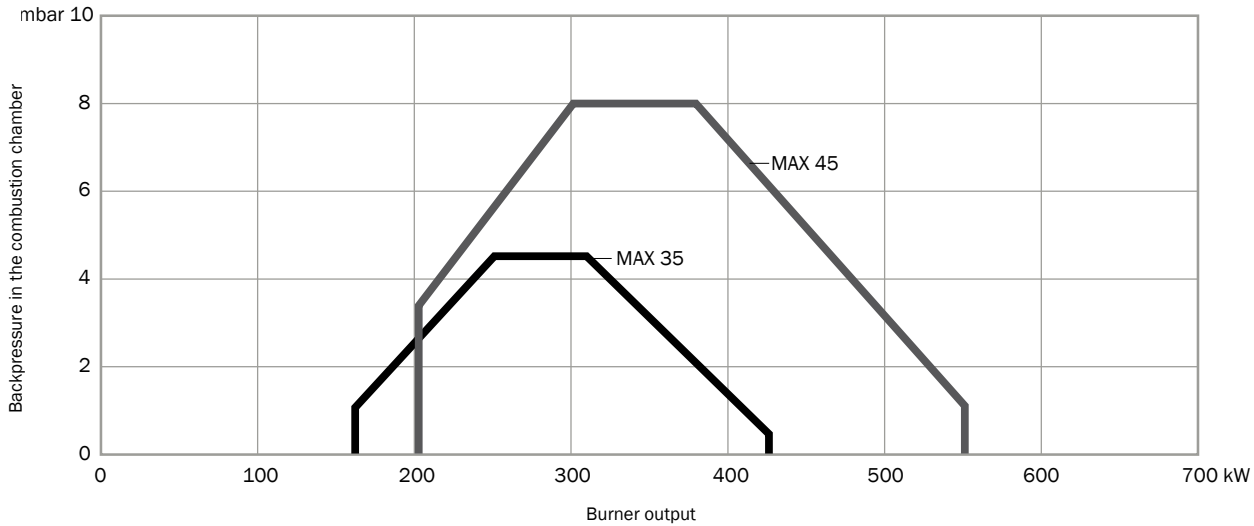

TECHNICAL DATA

	Burner output (kW)	Flow rate (kg/h)	Power supply	Motor (W)	NOx class	Operation
MAX P 35 AB	166 - 427	14 - 36	1/230V/50Hz	300	Class 2	AB
MAX P 45 AB	202 - 546	17 - 46	3/230-400V/50Hz	550	Class 2	AB
MAX P 35 AB HS	166 - 427	14 - 36	1/230V/50Hz	300	Class 2	AB HS
MAX P 45 AB HS	202 - 546	17 - 46	3/230-400V/50Hz	550	Class 2	AB HS

OVERALL DIMENSIONS

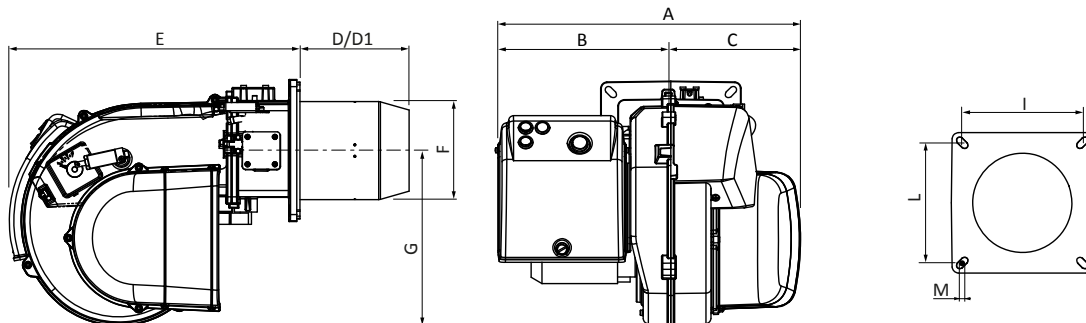

Dimensions in mm
 Head length: D short / D1 long

	A	B	C	D	D1	E	F	G	I	L	M
MAX P 35	501	294	207	175	365	466	160	280	185/200	185/200	M8
MAX P 45	501	294	207	175	365	466	160	280	185/200	185/200	M8

HEAD OFFICE:
Via Roma, 64
31023 Resana (TV)

REGISTERED OFFICE:
Viale A. Merloni, 45
60044 Fabriano (AN)

Tel.: +39 0423 719500
Fax: +39 0423 719580
Email: export@ecoflam-burners.com

Company subject to the direction and coordination of Ariston Group, Via A. Merloni, 45 - 60044 Fabriano (AN) - Italy

Version 1.2 - 01/02/2022

ECOFLAM Bruciatori S.p.A. reserve the right to make any adjustments, without prior notice, which is considered necessary or useful to its products, without affecting their main features.