

Smart Watch

User Manual



◆ Downloading the App

Scan the following QR code, download and install the App.

Da Fit

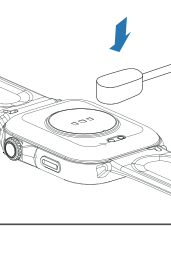

Scan QR Code and Download

◆ Downloading the App

Charging the device to active before the first time using;
To charge your device, plug the charging cable into the
adaptor or USB port on your computer.

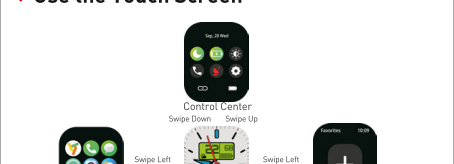

◆ Pairing

Open the App and set up your profile



Go to the [Device] , Click Add a [Device]



Choose your device on the scanning list



Finish

The MAC address on the “Setting”-“About” page could
help you identify your device on the scanning list.

◆ Use the Touch Screen

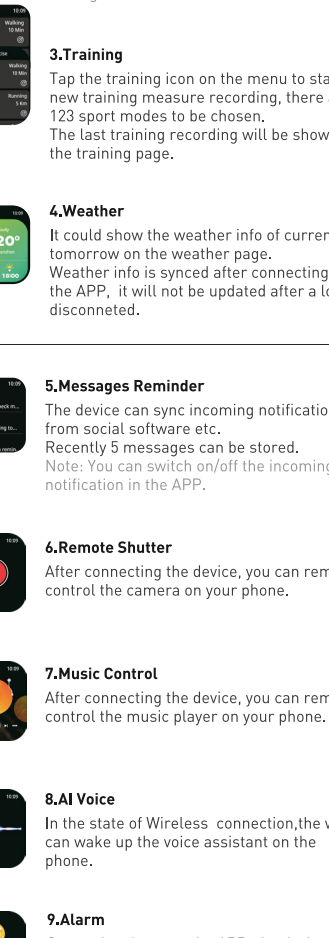

1.Wireless Calling

After connecting the Smart Watch to the
phone, you can use the watch to dial to
control the phone for making calls and
answering the phone calls.You can also view
the call history of the watch.You need to keep
the connection between the watch and the
phone stable when using the Phone Call
function.



2.Sports

Smart Watch automatically tracks Steps
taken on the screen.

NOTE: Your movement stats reset to zero at
midnight.

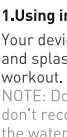

3.Training

Tap the training icon on the menu to start a
new training measure recording, there are
123 sport modes to be chosen.

The last training recording will be shown on
the training page.

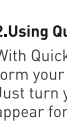

4.Weather

It could show the weather info of current and
tomorrow on the weather page.

Weather info is synced after connecting with
the APP, it will not be updated after a long
disconnected.

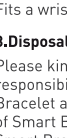

5.Messages Reminder

The device can sync incoming notifications
from social software etc.

Recently 5 messages can be stored.

Note: You can switch on/off the incoming
notification in the APP.



6.Remote Shutter

After connecting the device, you can remote
control the camera on your phone.

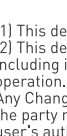

7.Music Control

After connecting the device, you can remote
control the music player on your phone.

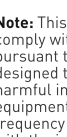

8.AI Voice

In the state of Wireless connection,the watch
can wake up the voice assistant on the
phone.

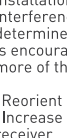

9.Alarm

Set up the alarm on the APP, the device will
vibrate to remind on time.

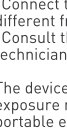

10.Remind to Move

The device will vibrate to remind you to make
a relax after 1 hour sitting.

Note: You can switch on/off the feature in the
APP.



11.Remind to Drink

The smart watch will remind you “Time to
Drink Some Water” at the planned drinking
time.

Note: You can set the feature in the APP.

12.Other Features

Other features include stopwatch, alarm,
timer, brightness,mute on/off, theater
mode,factory reset, power off and about.

◆ Getting to Know Your Device

1.Using in Wet Conditions

Your device is water-resistant, which means it is rainproof
and splash-proof and can stand up to even the sweatiest
workout.

NOTE: Do not swim with your Smart Bracelet. We also
don't recommend showering with your wristband; though
the water won't hurt the device, wearing it 24/7 does not
give your skin a chance to breathe. Whenever you get your
bracelet wet, dry it thoroughly before putting it back on.

2.Using Quick View

With Quick View you can check the time or the message
from your phone on your Smart Bracelet without tapping.
Just turn your wrist towards you and the time screen will
appear for a few seconds.

◆ General Info & Specifications

1.Environmental Conditions

Operating temperature: 14°F to 122°F (-10°C to 50°C)

Non-operating temperature: -4°F to 140°F (-20°C to 60°C)

2.Size

Fits a wrist between 5.5 and 7.7 inches in circumference.

3.Disposal and Recycling

Please kindly be aware that it is the consumer's
responsibility to properly dispose and recycle Smart
Bracelet and accompanying components. Do not dispose
of Smart Bracelet with common household waste, the
Smart Bracelet unit is considered electronic waste and
should be disposed of at your local electronic equipment
collection facility.

For more information, please contact your local
electronic equipment waste management authority or the
retailer where you bought the product.

◆ FCC Warning

This device complies with part 15 of the FCC Rules.
Operation is subject to the following two conditions:

(1) This device may not cause harmful interference, and
(2) This device must accept any interference received,
including interference that may cause undesired
operation.

Any Changes or modifications not expressly approved by
the party responsible for compliance could void the
user's authority to operate the equipment.

Note: This equipment has been tested and found to
comply with the limits for a Class B digital device,
pursuant to part 15 of the FCC Rules. These limits are
designed to provide reasonable protection against
harmful interference in a residential installation. This
equipment generates uses and can radiate radio
frequency energy, if not installed and used in accordance
with the instructions, may cause there is no guarantee
that interference will not occur in a particular
installation. If this equipment does cause harmful
interference to radio or television reception, which can be
determined by turning the equipment off and on, the user
is encouraged to try to correct the interference by one or
more of the following measures:

- Reorient or relocate the receiving antenna.
- Increase the separation between the equipment and
receiver.
- Connect the equipment into an outlet on a circuit
different from that to which the receiver is connected.
- Consult the dealer or an experienced radio/TV
technician for help.

The device has been evaluated to meet general RF
exposure requirement. The device can be used in
portable exposure condition without restriction.

