

Design, Quality & Production Made in Italy 



 **PASQUALICCHIO**  
il caldo ecologico

Aspiro

Scheda Tecnica Data Sheet

Caldie | Termostufe | Termocamini | Stufe  
[www.pasqualicchio.it](http://www.pasqualicchio.it)



## Aspiro



Aspiro	20	30	40	60	80
Focolare [kW] / Firebox output	24,36	35,38	54,52	74,01	96,28
Nominale [kW] / Nominal output	21,7	31,6	49,1	66,4	86,1
Rendimento / Efficiency	88,9	89,2	90,1	89,7	89,4
Misure Camera di combustione (Lu x La x H) [mm] / Combustion chamber dimensions (Len. x W x H)	410*400*420	560*400*420	560*490*490	700*490*490	850*490*490
Mandata/Ritorno Impianto (") / System Outlet/Inlet (")	1 - 1/2"	1 - 1/2"	1 - 1/2"	1 - 1/2"	1 - 1/2"
Mandata/Ritorno Sanitario (") / Sanitary Outlet/Inlet (")	1/2"	1/2"	1/2"	1/2"	1/2"
Pressione Nominale [bar] / Nominal Pressure [bar]	3	3	3	3	3
Contenuto Acqua [Lit] / Water Capacity [Lit]	100	120	144	171	190
Consumo Combustibile [kg/h]* / Fuel Consumption [kg/h]*	4,9	7,1	10,9	14,8	19,3
Temperatura mandata massima (°C) / Max Outlet Temperature (°C)	85	85	85	85	85
Temperatura minima ritorno (°C) / Max Inlet Temperature (°C)	50	50	50	50	50

Per dettagli tecnici ed approfondimenti su potenze 110 kW , 140 kW e 180 kW contattare il produttore.

For technical details and insights on 110 kW , 140 kW and 180 kW power, please contact the manufacturer.

[www.pasqualicchio.it](http://www.pasqualicchio.it)

\* I valori sono stati calcolati prendendo come riferimento un combustibile avente potere calorifico inferiore a 5 [kW \* h / kg].

\* The values have been calculated taking as reference a fuel with a calorific value lower than 5 [kW\* h/kg].

Scheda tecnica / Design options



Aspiro 20

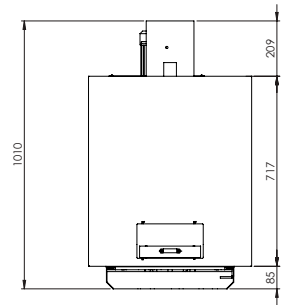
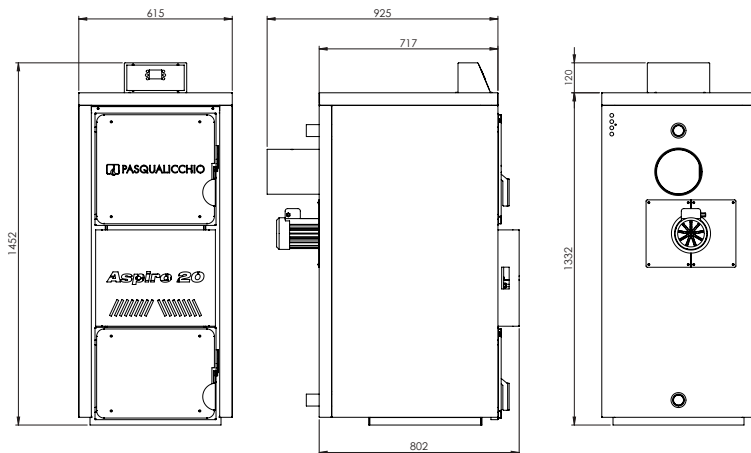

Scheda tecnica / Design options



Aspiro 30

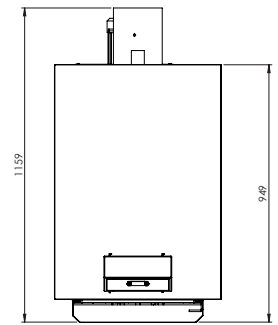
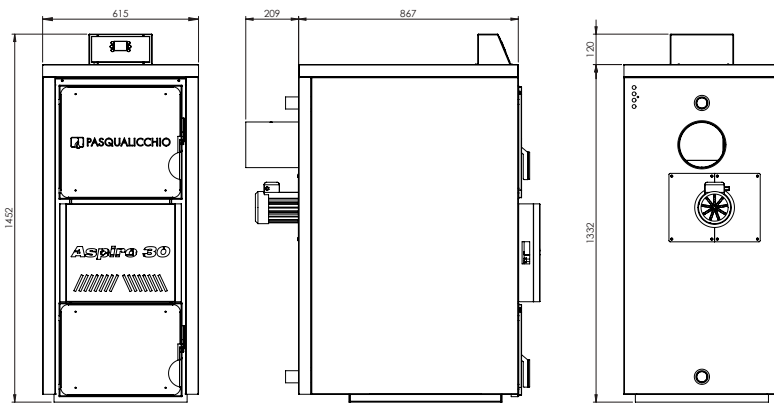

Scheda tecnica / Design options



Aspiro 40

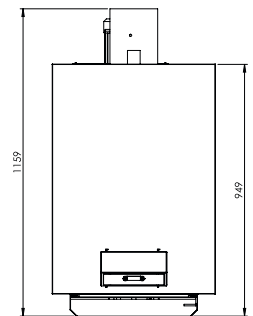
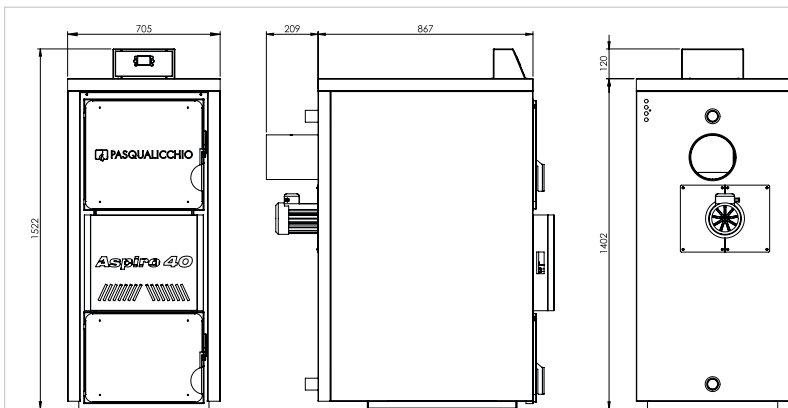

Scheda tecnica / Design options



Aspiro 60

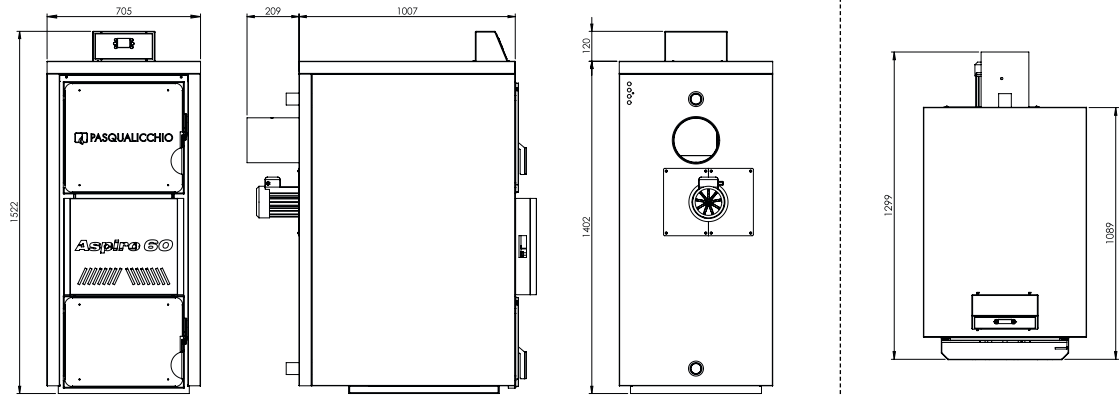

Scheda tecnica / Design options



Aspiro 80

